

DESCRIPTION

Composition: TegoBloc™ LiquiSeal is a trowel-grade sealant composed of sodium bentonite and butyl rubber. The combination of sodium bentonite and butyl rubber ensures its effectiveness in various surface preparation and waterproof detailing applications.

Water Activation: LiquiSeal has the unique property of swelling upon contact with water. This swelling action enhances its ability to create a watertight seal, making it effective in preventing water intrusion.

Compatibility: Designed specifically for use with Voltex waterproofing membranes. Ensures compatibility and optimal performance when used in conjunction with these membranes.

Consistency: LiquiSeal exhibits the consistency of thick grease, facilitating ease of application. This characteristic allows for smooth and uniform application on a variety of substrate materials.

Application Method: Applied using a trowel, which provides control over the thickness and coverage of the sealant. Bonds effectively to most substrate materials, ensuring a secure and reliable seal.

Versatility: Suitable for a variety of surface preparation tasks, including waterproof detailing work. Its versatility makes it a valuable component in creating comprehensive waterproofing solutions.

Benefits: Provides an effective barrier against water intrusion, contributing to the overall waterproofing system. Offers ease of handling and application due to its grease-like consistency. Facilitates a reliable bond with different substrate materials.

Considerations: When applying LiquiSeal, it's essential to follow manufacturer guidelines and recommended application techniques. Adherence to proper surface preparation methods enhances the effectiveness of the sealant. TegoBloc™ LiquiSeal serves as a crucial component in waterproofing applications, particularly when working with Voltex membranes. Its unique composition and swelling characteristics make it a valuable tool for achieving watertight seals in various construction scenarios. Always refer to the manufacturer's guidelines for optimal usage.

APPLICATIONS

TegoBloc LiquiSeal Applications and Guidelines:

Fillet Material: Utilized as fillet material at both horizontal and vertical inside corners. Ensures proper sealing and waterproofing at these critical junctions.

Flashing Material: Applied as flashing material around drains, mechanical and electrical penetrations, as well as curbs and parapets. Creates a watertight seal and prevents water intrusion at vulnerable areas.

Sealing Material: Functions as a sealing material at waterproofing terminations. Provides a secure and durable seal to prevent water ingress at termination points.

Repair Material: Used as a repair material for addressing small concrete substrate surface defects before waterproofing membrane installation. Helps in achieving a smooth and even surface for membrane application.

Trowel-Grade Waterproofing: Acts as a trowel-grade waterproofing solution for extremely irregular substrate surfaces. Ensures comprehensive waterproofing coverage, even on challenging surfaces.

Compatibility: Formulated for use on structural concrete, masonry, wood, and most metal surfaces. Offers versatility and suitability for various construction materials.

Limitations: Not recommended for use on extruded polystyrene (EPS) concrete forming systems. Use only in applications with proper confinement to ensure effective performance. Backfill soils should be compacted to an 85% Modified Proctor density for optimal results. Not intended for use as an expansion joint sealant.

TegoBloc™ LiquiSeal serves as a versatile accessory product for below-grade waterproofing applications, providing reliable sealing and protection against water intrusion. Its formulation and application versatility make it an essential component in ensuring the integrity of waterproofing systems. Always adhere to manufacturer guidelines and specifications for the best outcomes.

INSTALLATIONS

TegoBloc LiquiSeal Applications and Guidelines:

Thickness and Temperature: Apply LiquiSeal at a thickness of 1/4" (6 mm), unless specified otherwise in project details or by the manufacturer. Application is suitable where ambient and surface temperatures are -4°C (25°F) or above. Store LiquiSeal above 4°C (40°F) before application.

Surface Preparation: Ensure all surfaces to receive LiquiSeal are dry and free of contaminants such as dirt, dust, grease, rust, oil, curing agents, etc. Application can be done on structural concrete surfaces as soon as forms are removed. Achieve optimal adhesion and minimize waste by using a fine hair broom or equivalent finish. Apply LiquiSeal just prior to the installation of the waterproofing membrane.

Timing and Exposure: Avoid leaving LiquiSeal exposed for prolonged periods before concrete or backfill placement.

Penetration Areas: Around penetrations, LiquiSeal application should fill the space between TegoBloc Swell waterproofing membrane and the penetration. Maintain a minimum fillet thickness of 3/4" (19 mm) around the penetration, ensuring continuity. Extend LiquiSeal onto the penetration by 1-1/2" (36 mm) at a thickness of 3/16" (5 mm). For hydrostatic conditions with a head of 33' (10 m) or greater, double the above application rates. These guidelines ensure proper application of TegoBloc™ LiquiSeal, creating a reliable and effective seal for various construction applications. Always follow project details, manufacturer recommendations, and industry best practices for the best results.

PACKAGING

TegoBloc™ LiquiSeal is available in 3-gallon (11.3 liter) pails; 30 pails per pallet. Each pails weighs 36 lbs. (16.3 kg).

SHIPPING, STORAGE AND CLEAN UP

TegoBloc LiquiSeal Shipping and Safety Recommendations:

Shipping Instructions: Ship TegoBloc™ LiquiSeal via ground trucking service. *Caution: Do not ship LiquiSeal via air freight.*

Additional Shipping Information: Refer to the Material Safety Data Sheet (MSDS) for any supplementary shipping information.

Storage Guidelines: Keep LiquiSeal cans always sealed when not in use. Store above 4°C (40°F) in a dry storage area. Store away from heat and flames.

Tool Cleaning: Clean tools with a damp rag before the mastic has cured.

Worker Safety: Workers should wear protective clothing and eye protection. Avoid eye and skin contact, especially with open cuts. In case of eye contact, wash immediately. Do not ingest LiquiSeal.

MSDS Reference: Refer to the Material Safety Data Sheet (MSDS) for additional warnings and product safety information. Ensuring proper shipping methods, storage conditions, and worker safety practices is crucial for the effective and safe use of TegoBloc™ LiquiSeal. Always refer to the MSDS for comprehensive safety information and guidelines.

APPLICATION ILLUSTRATIONS

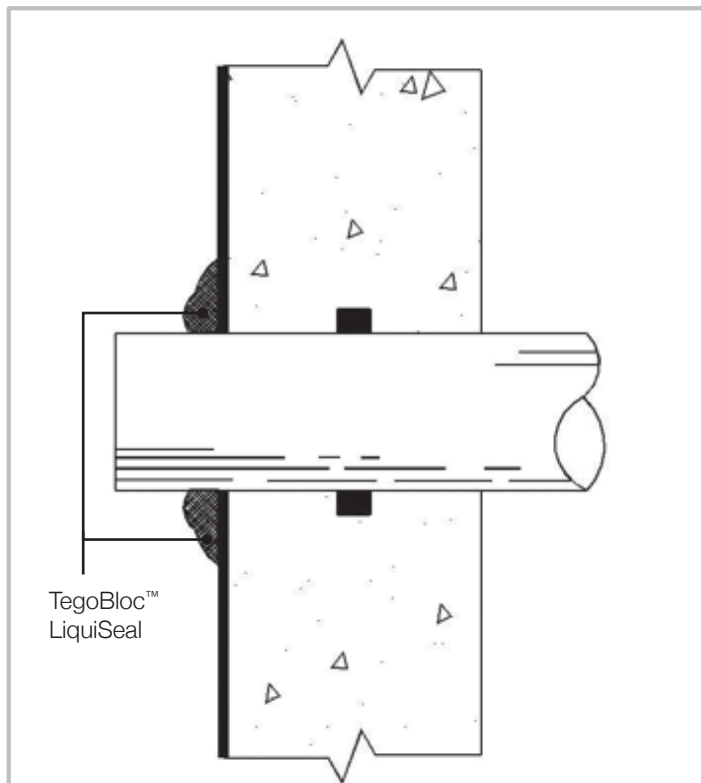

PENETRATIONS

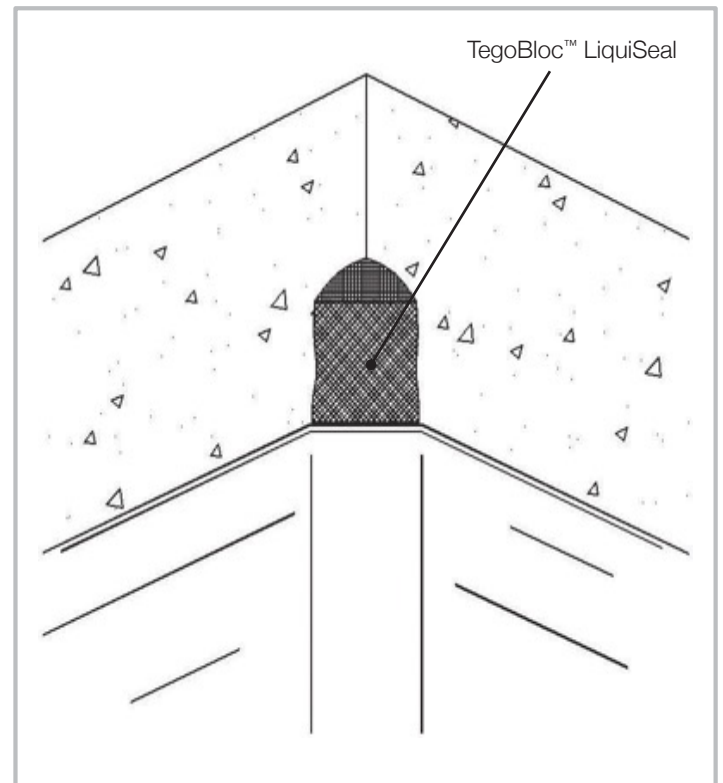

INSIDE CORNERS

TEGOBLOC™ LIQUISEAL

7 SHEET APPLIED | Membrane Waterproofing



A Garland Industries Subsidiary



COMMERCIAL

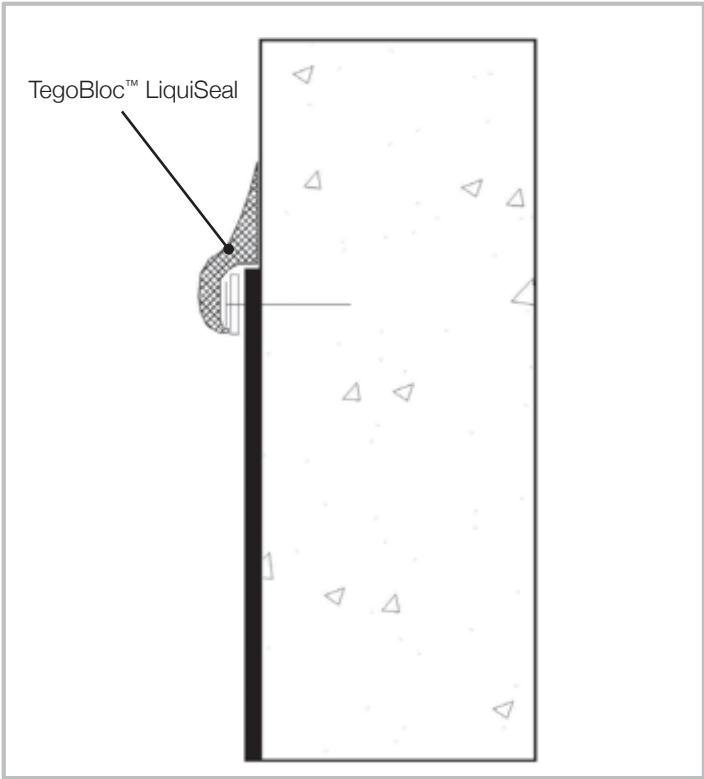

GRADE TERMINATIONS

APPROXIMATE COVERAGE RATE GUIDE

USAGE	TYPICAL COVERAGE
3/4" (19 mm) inside corner fillet	27 lin. ft./gallon (2.1 m/l)
As a 90-mil thick flashing material	15 sq. ft./gallon (0.37 sq. m/l)
3/4" (18 mm) inside corner fillet with 6" (150 mm), 90-mil (2.3 mm) thick extensions	9.5 lin. ft./gallon (0.76 m/l)

Product usage will vary because of site conditions and installation procedures. Actual usage rates will vary.



GMX, Inc.
3014 Chamber Dr.
Monroe, NC 28110
Toll Free: 866-228-7743
www.gmxwaterproofing.com

Results may differ based upon statistical variations depending upon mixing methods and equipment, temperatures, application methods, test methods, actual site conditions and curing conditions. Installation conditions and methods can impact product performance. Consult your local GMX Sales Representative for Questions.

PRIOR TO EACH USE OF ANY GMX PRODUCT, THE USER MUST ALWAYS READ AND FOLLOW THE WARNINGS & INSTRUCTIONS ON THE PRODUCT'S MOST CURRENT PRODUCT DATA SHEET, PRODUCT LABEL AND SAFETY DATA SHEET WHICH ARE AVAILABLE ONLINE AT WWW.GMXCO.COM OR BY CALLING GMX AT 866-228-7743. NOTHING CONTAINED IN ANY GMX MATERIALS RELIEVES THE USER OF THE OBLIGATION TO READ AND FOLLOW THE WARNINGS AND INSTRUCTIONS FOR EACH GMX PRODUCT AS SET FORTH IN THE CURRENT PRODUCT DATA SHEET, PRODUCT LABEL AND SAFETY DATA SHEET PRIOR TO PRODUCT USE.

5/2024 (6)