

IF TERMINATED AT TOP  
OF PLANTER, INSTALL  
TERMINATION BAR WITH  
BEAD OF ULTRA-GUARD  
EFS SEALANT

1. DRAIN-MAX 650
2. ULTRA-GUARD GB
3. ULTRA-GUARD ELASTOMERIC HB
4. ULTRA-GUARD REINFORCING FABRIC
5. STRUCTURAL CONCRETE DECK

TOP OF PLANTER CONDITIONS VARY  
BY PROJECT. REFER TO PROJECT  
CONSTRUCTION DOCUMENTS OR  
CONTACT GMX FOR RECOMMENDATIONS  
REGARDING TOP OF PLANTER WALL.

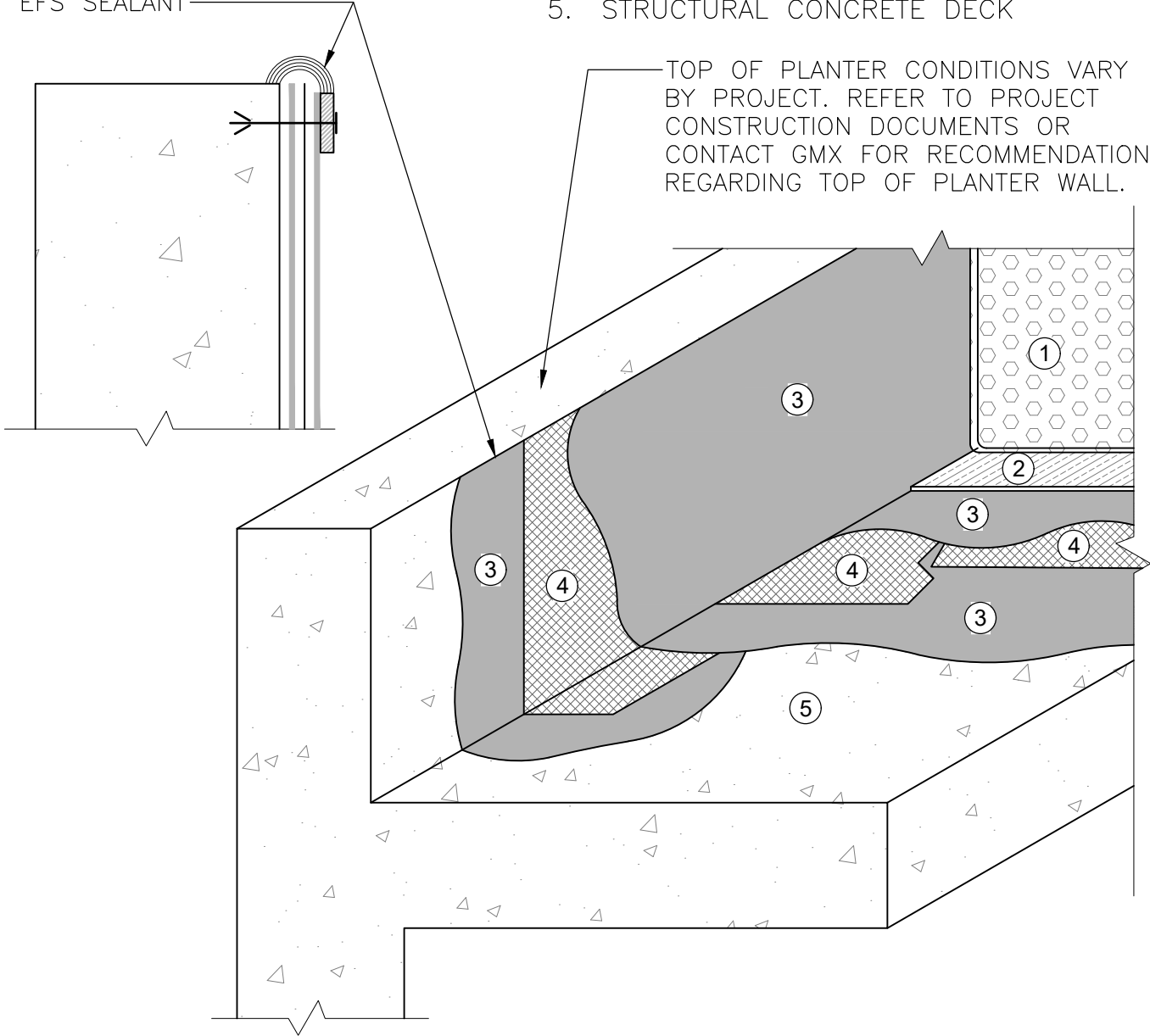

NOTES:

1. SYSTEM DETAIL DEPICTS 2 PLY POLYESTER REINFORCED  
ULTRA-GUARD ELASTOMERIC HB MEMBRANE.
2. REFER TO SPECIFICATION AND TECHNICAL DATA SHEETS AT  
GMXCO.COM FOR ADDITIONAL INFORMATION.

DRAWINGS ON 8 1/2"x11 TITLE BLOCKS ARE NOT TO SCALE.

ULTRA GUARD HA-551 WATERPROOFING SYSTEM

PLANTER DETAIL



DETAIL ID:		HA-20	
REPRESENTATIVE:			
DATE:		SHT:	OF